

DUAL FOLDBOT

Basic Info

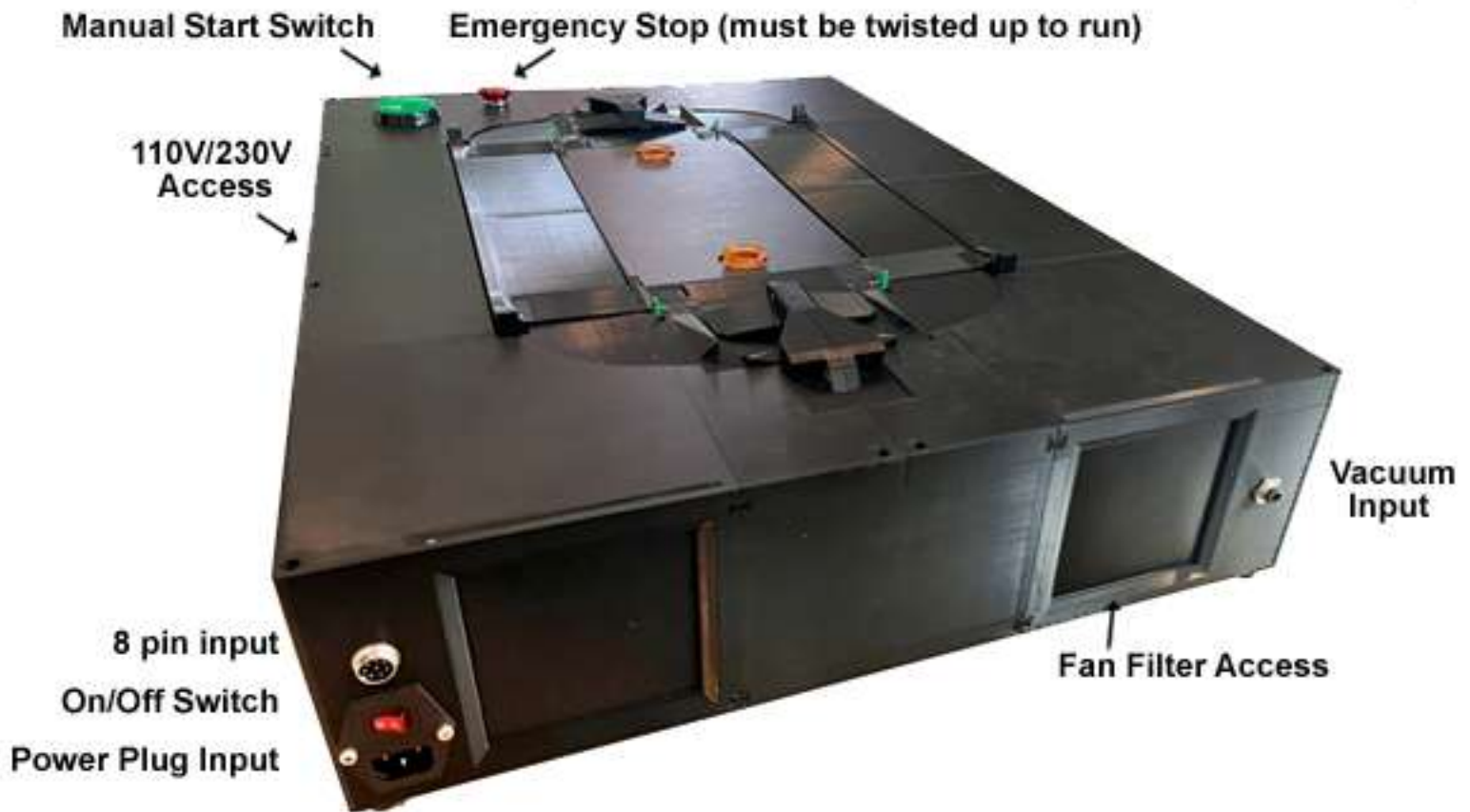

Front Arm

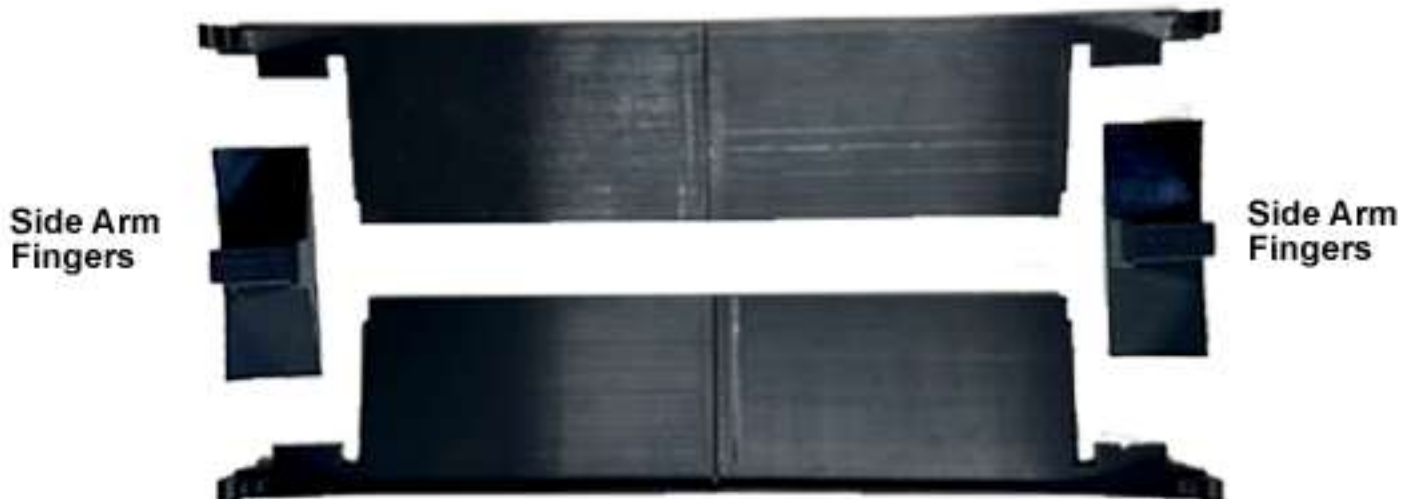

Back Arm

- FoldBot is currently set up to fold the smaller DL18033.
- On power up, FoldBot will "Home" by lifting both Side Arms with Fingers up to about a 70 degree angle and cycling up and down the Front and Back Arms.
- To switch to fold the larger DL 20010, swap out Front Arm (2 screws), Back Arm (2 screws) and both Side Arm Fingers (1 screw each).